

Freedom Pet Pass

Energy-Efficient Pet Doors

Door Installation Instructions

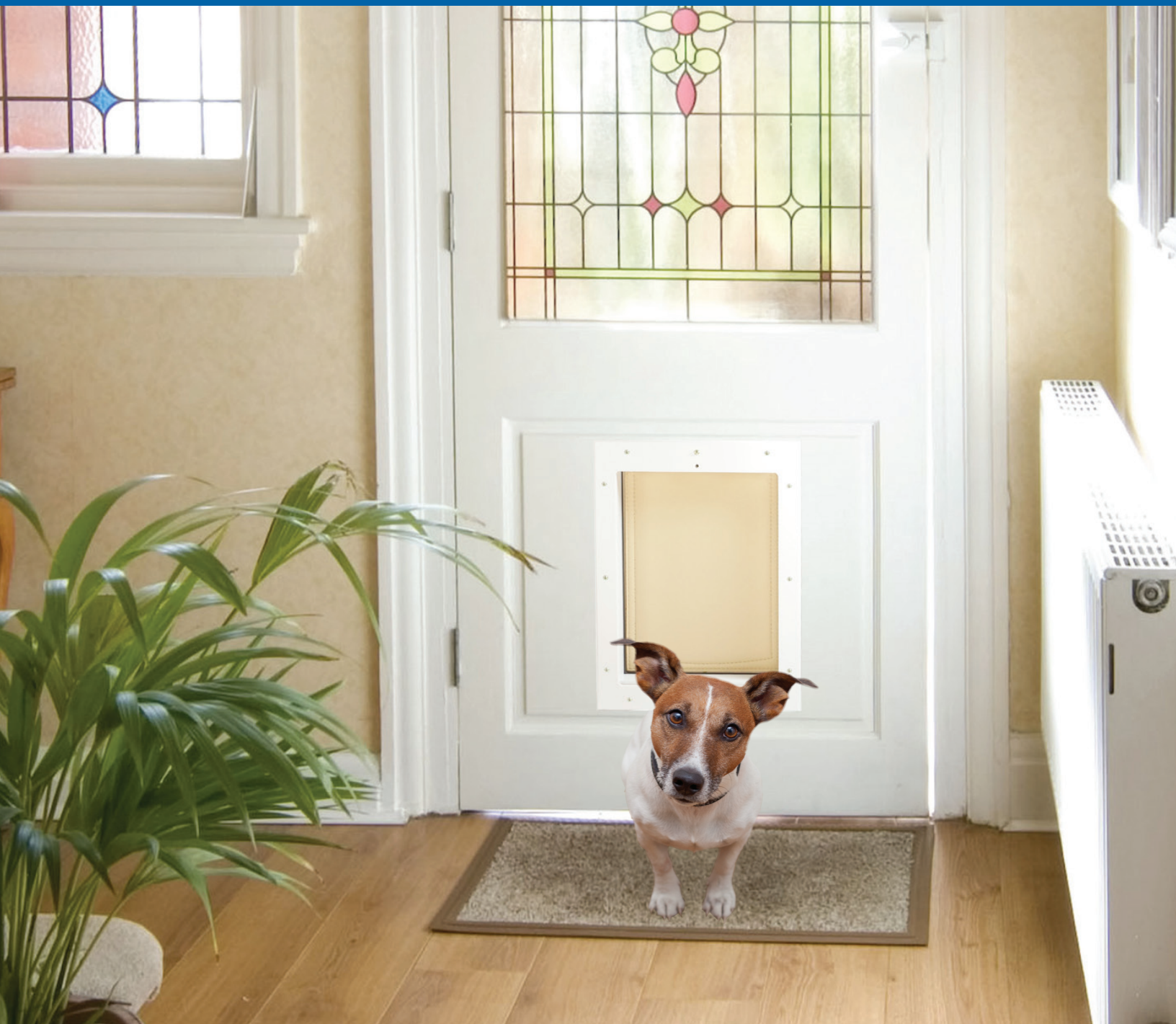

These installation instructions assume a modest level of experience and comfort with tools and home improvement projects. If you are not certain about your abilities in these areas, please consult with a building professional for installation.

Tools

Tools required to install a Freedom Pet Pass into a raised panel door include the following:

Safety glasses	Ear protection	Tape measure
Clamps	Phillips screw driver	Shield
Circular Saw (<i>with appropriate blade</i>)	Blue painters tape	File
(<i>i.e. metal blade for metal door, etc.</i>)	Level or straight edge	Square
Caulk gun		

Measurements required for installation of a Freedom Pet Pass door:

DOG DOOR SIZE	PET OPENING	ROUGH OPENING	OVERALL DIMENSIONS
Petite Cat Door	6½" x 7" (165mm x 180mm)	9" x 11½" (230mm x 290mm)	10¼" x 12½" (260mm x 320mm)
Small Dog / Cat Door	6" x 10" (155mm x 255mm)	10" x 14½" (255mm x 370mm)	11" x 15½" (280mm x 395mm)
Medium Dog Door	9" x 13" (230mm x 330mm)	13" x 17½" (330mm x 445mm)	14" x 18½" (355mm x 470mm)
Large Dog Door	11" x 17" (280mm x 430mm)	15" x 21½" (380mm x 545mm)	16" x 22½" (405mm x 570mm)
Extra Large Dog Door	16" x 23" (405mm x 595mm)	20¾" x 29" (530mm x 740mm)	22" x 30" (560mm x 760mm)

Step 1: Determine the rough cut line

- A. Begin the project with the interior side of your home door facing up on saw horses.
- B. Locate and place the product where it will best fit your door and your pet.
- C. The best placement is one that is ergonomically correct in height for all your pets. The perfect fit has the top of the pet opening about an inch to an inch and a half higher than your tallest pet at the shoulders.
 - a. If you want to test your measurements, you can test using a large piece of cardboard.
 - i. Cut a hole in the cardboard the size of the pet opening. Fold the cardboard at the bottom so that the top of the pet opening is 1" to 1-1/2" higher than your tallest pet at the shoulders.
 - ii. Place the cardboard in a doorway and invite your pet to pass through the opening. Your pet should not have to jump or crouch to pass through.
 - b. *Note: do not mount the pet door too low on your home door. This may damage the structural integrity.*
- D. Make a line where the top of the pet opening should be on the door, using either your measurement or your cardboard cutout.
- E. Take the pet door (the piece with the flap) and place the inside center of the frame on the line that you've drawn to determine the height that will best fit your door and your pet.
- F. Double check your side measurements to make sure your door is squared.
- G. Double check your height measurements.
- H. When the door is squared and at the desired height, trace around the outside of the door with a pencil.



Step 1: Determine the opening

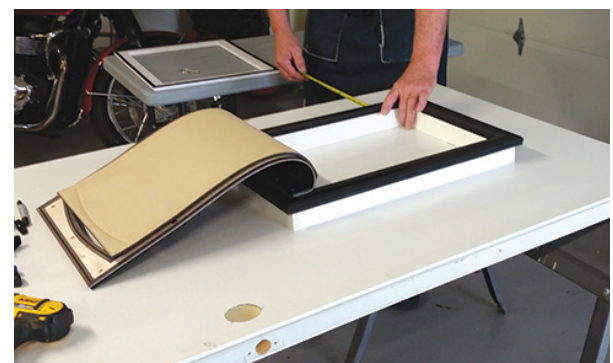

Step 1: Double Check and trace

Step 2: Cutting the rough cut

- A. Begin with a good saw and the proper blade installed to cut through your home door application. Use a metal blade for metal doors, a wood blade for wood doors, etc. If possible, use a new blade when cutting the opening. We don't recommend cutting into the door if it is your first time using a saw.
- B. Start your cut at the back corner and work around the door.
- C. Line up the saw blade with the pencil line and with a good grip on the saw carefully begin your cut.
- D. Once the cut is complete on the inside of the door, flip the door over on the sawhorses (to external side). Use clamps and a bar to secure the cutout in place. You don't want it dropping through prior to completing the cut.
- E. Use a square to trace in the corners that still need to be cut. Use the saw to make the final cuts in the corners.
- F. Tap out the cut piece to reveal the rough opening. File the edges if needed.

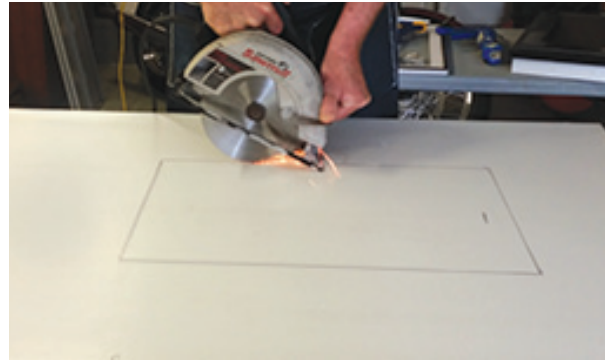

Step 2: Cutting the rough cut

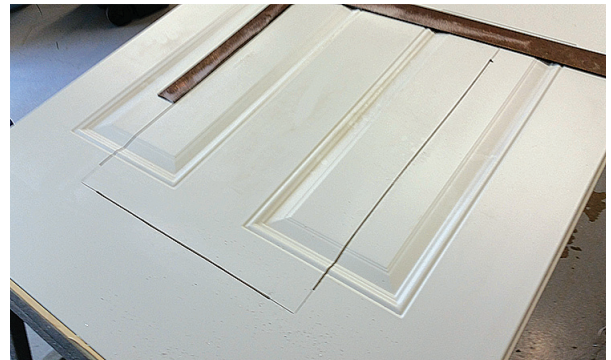

Step 2: Finish the rough cut

Step 3: Attach the pet door

- A. Place the pet door into the hole with the outside (dark brown) oriented to the exterior side of the door and the hinge of the flap oriented toward the top.
- B. Clamp the pet door in place, and flip the door over.
- C. Place the interior frame on the door. Align the interior frame to the rest of the pet door using the locking pin on the top and the bottom middle screw to ensure that the two pieces are mated squarely.
- D. Put the other screws into the other holes, and then carefully tighten.

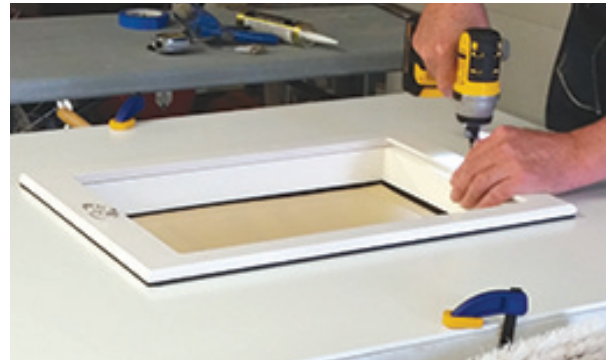

Step 3: Attach the pet door

Step 4: Seal the frame

- A. On both the exterior door and the pet door, place tape 3/8" from the edge where the pet door meets the exterior door. This frames in the area for the caulk bead. Fill with caulk and remove the tape.
- B. Flip the door over and remove the clamps.
- C. Repeat the taping and caulking step on the exterior side.

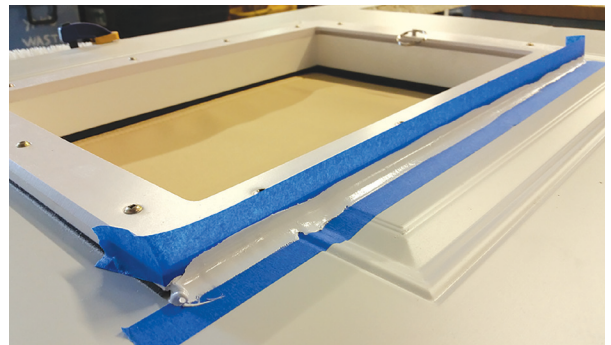

Step 4: Seal the frame

WARNING: TODDLERS AND CHILDREN CAN FIT THROUGH PET DOORS AND MAY ESCAPE OUTSIDE UNATTENDED.

DO NOT use the security panel to lock your pet out from the inside. Pets cannot see whether the security panel is in place and may hurt themselves and/or damage the door attempting to re-enter.

DO NOT force your pet through the pet flap when training it to use the pet door. This can make them afraid of the pet door.

DO NOT rely solely on the chew guard to prevent a mischievous pet from chewing the magnetically lined flap seal. The chew guard simply reduces the damage a pet may cause.

DO NOT allow leashed pets to pass through the door. The leash can become tangled and possibly hurt your pet.

DO NOT allow children to use the pet door.

DO NOT allow dogs to run through the dog door at high speed

DO reward with treats and praise during the training period.

DO consider lifting and temporarily tying the outside black U-shaped flap seal securely up out of the way (only if needed). This can make it easier for your pet to initially get through the pet door when they're still unsure of it. Untie once your pet has gotten the hang of going in and out.

DO consider the use of an anti-chewing product to discourage your pet from chewing if needed. Dried ground Habanero pepper sprinkled sparingly in a smudge of Vaseline and applied to the inside of the black flap seal between the magnets has been safely used by some owners. Consult with your veterinarian first before applying.

DO use a non-detergent cleanser (Woolite) and a soft scrub brush to remove dirt from the canvas coated pet flap.

DO remove debris from magnets with a dry rag once a month for optimal sealing.

Pet Door Training Tips

Finally, you have your new pet door installed! However, your pet will not instantly know what it is or how to use it. You may have to teach them how. Be prepared for it to take some time. Many pets learn to use pet doors within a very short time. But others, especially timid or anxious pets, might take a little longer. Be patient, don't rush it, and don't overtrain (short sessions every other day). Above all, don't force your pet to pass through, this can make them scared of the door.

The traditional method of training a pet to use a pet door is really just a matter of showing the pet the door opening, slowly opening the flap when someone else calls the pet from the opposite side of the opening enticing them to pass through. Of course, when they do come through, reward them with a treat, and spend a few minutes petting and playing with them before repeating the exercise. Many pets will catch on in just a few minutes, others will take a day or two. For the slower learners, lift and temporarily tie the outside black U-shaped flap seal securely up and out of the way. This will introduce their new access location in a simpler way. To encourage your pet to use the dog door, reward with treats and praise. After they have become familiar with the new passage, untie and lower the flap seal and allow the DoubleMag™ flap seal to provide the airtight, energy-efficient seal.